

M-Bus Gateway RF enables to get data access from M-Bus networks to RF devices (meters with EM1016, EM1017, EM1024 units), and other devices and networks that might be utilizing open protocols (such as Modbus RTU and other). Supply voltage is 220/110 VAC, 300mA.

The module has built-in RS232, RS485, M-Bus interfaces, 3 pulse inputs from meters with pulse outputs and 1 digital input.

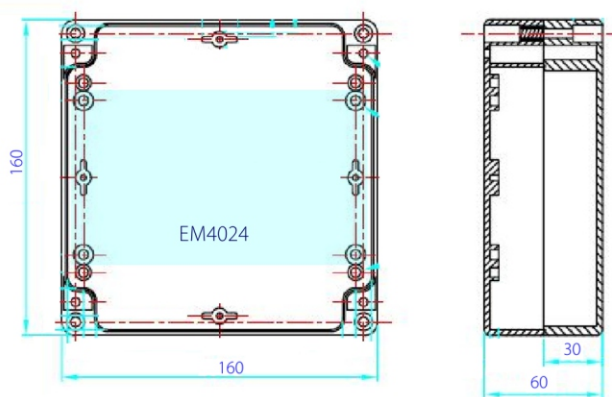

Main dimensions, mm



Parameters	Description
Description	M-Bus Gateway RF unit EM4024
Input Connection Types	3 pulse inputs from meters with pulse outputs, 1 digital input, serial RS232/RS485, M-BUS interfaces
Inputs Specification	Digital/pulse inputs: dry contact or open collector transistor. Maximum input cable length: digital/pulse inputs - 10 meters, RS232 - 50 m, RS485 - 600 m
Box Size	160x160x60mm
Unit Weight	800 g
Power Supply	220/110 VAC, 600 mA
RF Transmit Bitrate	10.0 kbps
RF frequencies (ranges)	FSK 430/860/900 MHz
Configuration Storage	Non-volatile memory
Operating Temperatures	-20° C to +60° C
Environmental	IP-65
Humidity	Max. 90%

Antenna RF

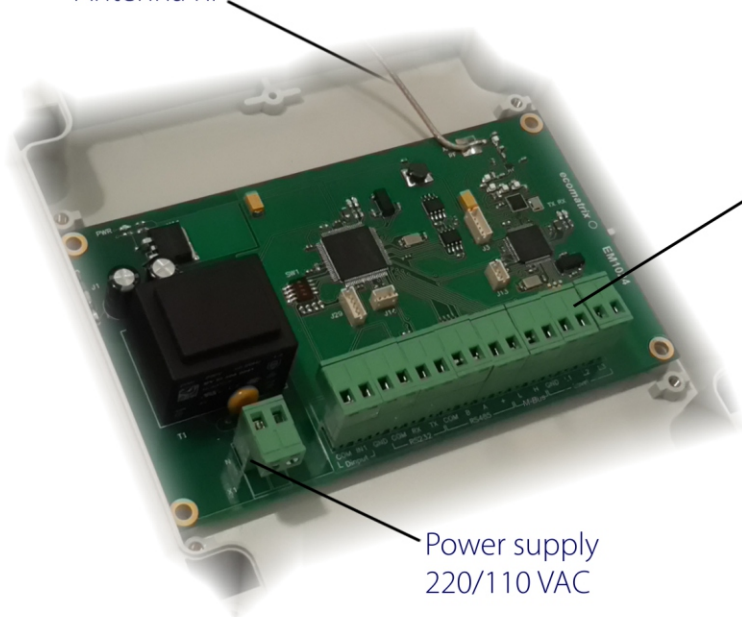

Power supply
220/110 VAC

Signals of connection terminals

COM	Dinput	Digital Input	
Dinput	Ground	Protective grounding of the unit	
GND			
+V			
COM	RS232	To devices with RS232 interface	
RX			
TX			
COM	RS485	To devices with RS485 interface	
B			
A			
+			
BUSL1	M-Bus	M-Bus Network or device	
BUSL2			
GND			
Pulse 1	Pulse	3 pulse inputs from meters	
Pulse 2			
Pulse 3			

The M-Bus Gateway RF is configurable to act as both a Master and a Slave M-Bus device.

As an M-Bus Master the number of devices supported is limited to up to 64 devices as the FieldServer provides power to the M-Bus. The M-Bus master interrogates the slave devices as the gateway acts as a Client. It will request information from the slave devices and receive and process only the expected responses.

As an M-Bus Slave the maximum number of devices on the M-Bus is limited to the M-Bus standard of 250. The M-Bus Gateway RF will act as a Server and will respond only to requests from the M-Bus master devices.

